

HG 系列 SERIES

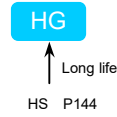

- 全焊结构，确保可靠的电气接触性
All-welded construction ensures reliable electrical contact
- 优异的导热能力与高耐纹波电流能力
Good thermal characteristics and high ripple current capability.
- 保证 105℃、10000 小时寿命。(叠加纹波电流)
Endurance with ripple current: 10000 hours at 105℃
- 应用：变频器、机车牵引装置和专业电源
Applications: Frequency converters, Traction and Professional power supplies



◆规格表 SPECIFICATIONS

项目 Items	特性 Characteristics								
工作温度范围 Operating Temperature Range	-40~+105℃								
额定工作电压范围 Rated Working Voltage Range	350~450V								
静电容量范围 Capacitance Range	1000~15000 μF								
静电容量允许偏差 Capacitance Tolerance	±20% (20℃, 120Hz)								
损耗角正切值 Dissipation Factor (MAX) 20℃, 120Hz	<table border="1"> <tr> <td>U_R(V)</td> <td>350</td> <td>400</td> <td>450</td> </tr> <tr> <td>tanδ</td> <td colspan="3">0.15</td> </tr> </table>	U _R (V)	350	400	450	tanδ	0.15		
U _R (V)	350	400	450						
tanδ	0.15								
漏电流 Leakage Current (MAX)	$I = 0.01C_R U_R$ 或 5mA 取小者 (20℃, 施加额定电压 5 分钟后) $I = 0.01C_R U_R$ or 5mA whichever is minimum. (at 20℃, After 5 minutes application of rated voltage) I=漏电流 (μA) U _R =额定电压 (V) C _R =静电容量 (μF) Leakage Current Rated Voltage Rated Capacitance								

	使用寿命 Useful Life	负荷寿命 Load Life	耐久性特性 Endurance Test	高温无负荷特性 Shelf Life
产品寿命 Life Time	12000h	>250000h	10000h	1000h
漏电流 Leakage Current	≤规定值 ≤ Specified value	≤规定值 ≤ Specified value	≤规定值 ≤ Specified value	≤规定值 ≤ Specified value
损耗角正切值变化率 tanδ Change	≤规定值的 300% ≤300% of specified value	≤规定值的 300% ≤300% of specified value	≤规定值的 175% ≤ 175% of specified	≤规定值的 150% ≤ 150% of specified
静电容量变化率 Capacitance Change	初始值±30%以内 Within±30% of initial value	初始值±30%以内 Within±30% of initial value	初始值±15%以内 Within±15% of initial	初始值±15%以内 Within±15% of initial
施加条件 Condition 施加电压 Applied Voltage 施加纹波电流 Applied Ripple Current 环境温度 Applied Temperature 失效等级 Failure Rate Level	U _R I _R 105℃ ≤1% Failure rate	U _R 1.2×I _R 40℃ ≤1% Failure rate	U _R I _R 105℃ 0%	U _R I _R =0 105℃ 0% Back up to 20℃ and placed more than 24 hours. U _R to be applied for 60 min before measurement.

◆尺寸图 Dimensions

- 常用端子型式代码：Terminal Code

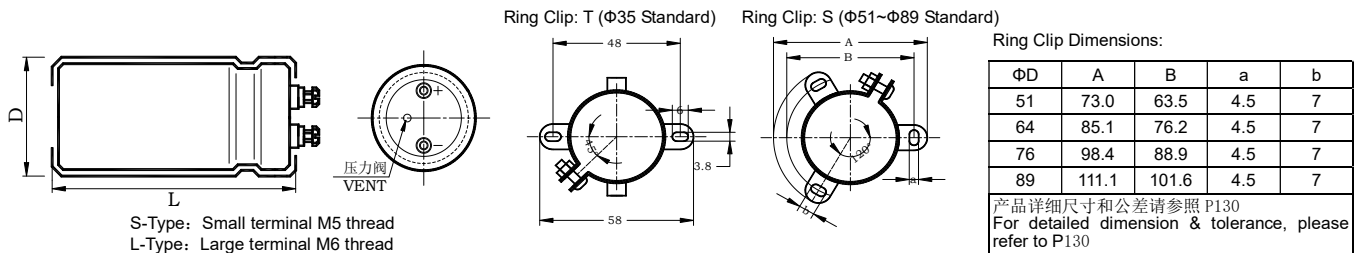

- 记载以外的端子形状，请另行咨询。Please consult to us for the terminal type not displayed in content

◆产品编码体系 PART NUMBER SYSTEM

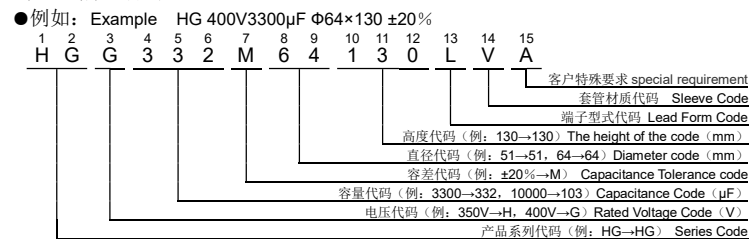

◆纹波电流修正系数 Rated Ripple Current Multiplies

●频率修正系数 Frequency coefficient

频率 Frequency (Hz)	50(60)	100(120)	300	1k	≥10k
系数 Coefficient	0.80	1.00	1.10	1.30	1.40

●温度修正系数 Temperature coefficient

温度 Temperature (℃)	+40	+60	+85	+105
系数 Coefficient	2.44	2.16	2.00	1.00

◆ 产品一览表 Standard Ratings

WV _{DC} (Surge Voltage) (V)	Cap (μ F)	Size D×L (mm)	$\tan\delta$ 20°C/120Hz	Ripple Current 105°C/120Hz z (A _{rms})	Catalog Part Number
350 (400)	1000	51×80	0.15	3.9	HGH102M51080□VA
	1200	51×95	0.15	4.5	HGH122M51095□VA
	1500	51×115	0.15	5.5	HGH152M51115□VA
	1800	51×130	0.15	6.2	HGH182M51130□VA
	2200	64×95	0.15	7.1	HGH222M64095□VA
	2700	64×115	0.15	8.3	HGH272M64115□VA
	3300	64×130	0.15	10.2	HGH332M64130□VA
	3900	76×115	0.15	11.3	HGH392M76115□VA
	4700	76×130	0.15	13.1	HGH472M76130□VA
	5600	76×155	0.15	14.7	HGH562M76155□VA
	6800	89×157	0.15	17.0	HGH682M89157□VA
	8200	89×157	0.15	19.1	HGH822M89157□VA
	10000	89×195	0.15	22.2	HGH103M89195□VA
	12000	89×235	0.15	25.5	HGH123M89235□VA
15000	89×250	0.15	29.3	HGH153M89250□VA	
400 (450)	1000	51×95	0.15	4.0	HGG102M51095□VA
	1200	51×115	0.15	4.8	HGG122M51115□VA
	1500	51×130	0.15	5.7	HGG152M51130□VA
	1800	64×95	0.15	6.4	HGG182M64095□VA
	2200	64×115	0.15	6.9	HGG222M64115□VA

WV _{DC} (Surge Voltage) (V)	Cap (μ F)	Size D×L (mm)	$\tan\delta$ 20°C/120Hz	Ripple Current 105°C/120Hz z (A _{rms})	Catalog Part Number
400 (450)	2700	64×130	0.15	8.7	HGG272M64130□VA
	3300	76×130	0.15	10.6	HGG332M76130□VA
	3900	76×155	0.15	12.1	HGG392M76155□VA
	4700	76×155	0.15	13.4	HGG472M76155□VA
	5600	89×157	0.15	15.6	HGG562M89157□VA
	6800	89×157	0.15	17.3	HGG682M89157□VA
	8200	89×195	0.15	19.8	HGG822M89195□VA
	10000	89×235	0.15	22.9	HGG103M89235□VA
	450 (500)	1000	51×130	0.15	4.7
1200		64×115	0.15	5.5	HGE122M64115□VA
1500		64×130	0.15	6.5	HGE152M64130□VA
1800		76×115	0.15	7.5	HGE182M76115□VA
2200		76×130	0.15	8.7	HGE222M76130□VA
2700		76×155	0.15	9.9	HGE272M76155□VA
3300		89×130	0.15	11.1	HGE332M89130□VA
3900		89×157	0.15	13.0	HGE392M89157□VA
4700		89×170	0.15	14.4	HGE472M89170□VA
5600		89×195	0.15	16.7	HGE562M89195□VA
6800		89×235	0.15	19.2	HGE682M89235□VA
8200	89×250	0.15	19.5	HGE822M89250□VA	

*产品编码中□内为产品端子引出型式代码

*□Enter the appropriate terminal code

*记载之外的体积，请另行咨询。

*Please ask for advice for other sizes.

*铝电解电容器由于承受纹波电流而发热，随着温升而发生性能劣化。请在使用中降低产品承受的纹波电流。

*Aluminum electrolytic capacitor will emit heat when ripple current is applied, the performance will deteriorate when temp. rises. Please reduce the ripple current when using capacitor.